

# PRIME FINANCIAL DISTRICT RETAIL CORNER

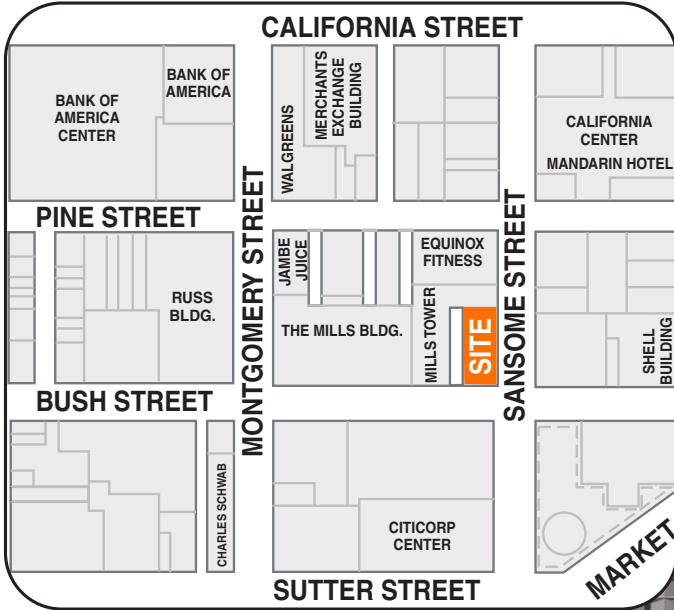

## AT THE CORNER OF BUSH ST.

- Dominant ground floor prime Financial District Retail Corner
- Approx. 130 ft of street frontage
- Size: 7,676 USF
- Rent: Negotiable
- Classic stately presence



SAN FRANCISCO

115 SANSOME STREET

For further information and arrangements to inspect contact:

**EDWARD PLANT COMPANY**



Jerry Moskowitz & Ted Plant  
p. 415-421-8098 / f. 415-421-0184  
jmoskowitz@edwardplantcompany.com  
tplant@edwardplantcompany.com

Edward Plant Company, Inc.  
601 California Street, #1500  
San Francisco, CA 94108

### SANSOME STREET

#### RECORD DOCUMENTS

NOTE: THIS DOCUMENT HAS BEEN PREPARED, IN PART, FROM INFORMATION COMPILED AND FURNISHED BY OTHERS. HUNTSMAN ARCHITECTURAL GROUP HAS NOT VERIFIED THAT INFORMATION. FUTURE LEASING AND CONSTRUCTION PLANNING MUST INCLUDE FIELD CONFIRMATION OF EXISTING CONDITIONS. USER'S ACCEPTANCE OF THIS INFORMATION SHALL HOLD HARMLESS HUNTSMAN ARCHITECTURAL GROUP AND THE SWIG COMPANY FOR ANY IRREGULARITIES BETWEEN THIS DOCUMENT AND EXISTING AS-BUILT CONDITIONS.

HUNTSMAN ARCHITECTURAL GROUP

SUITE # 101

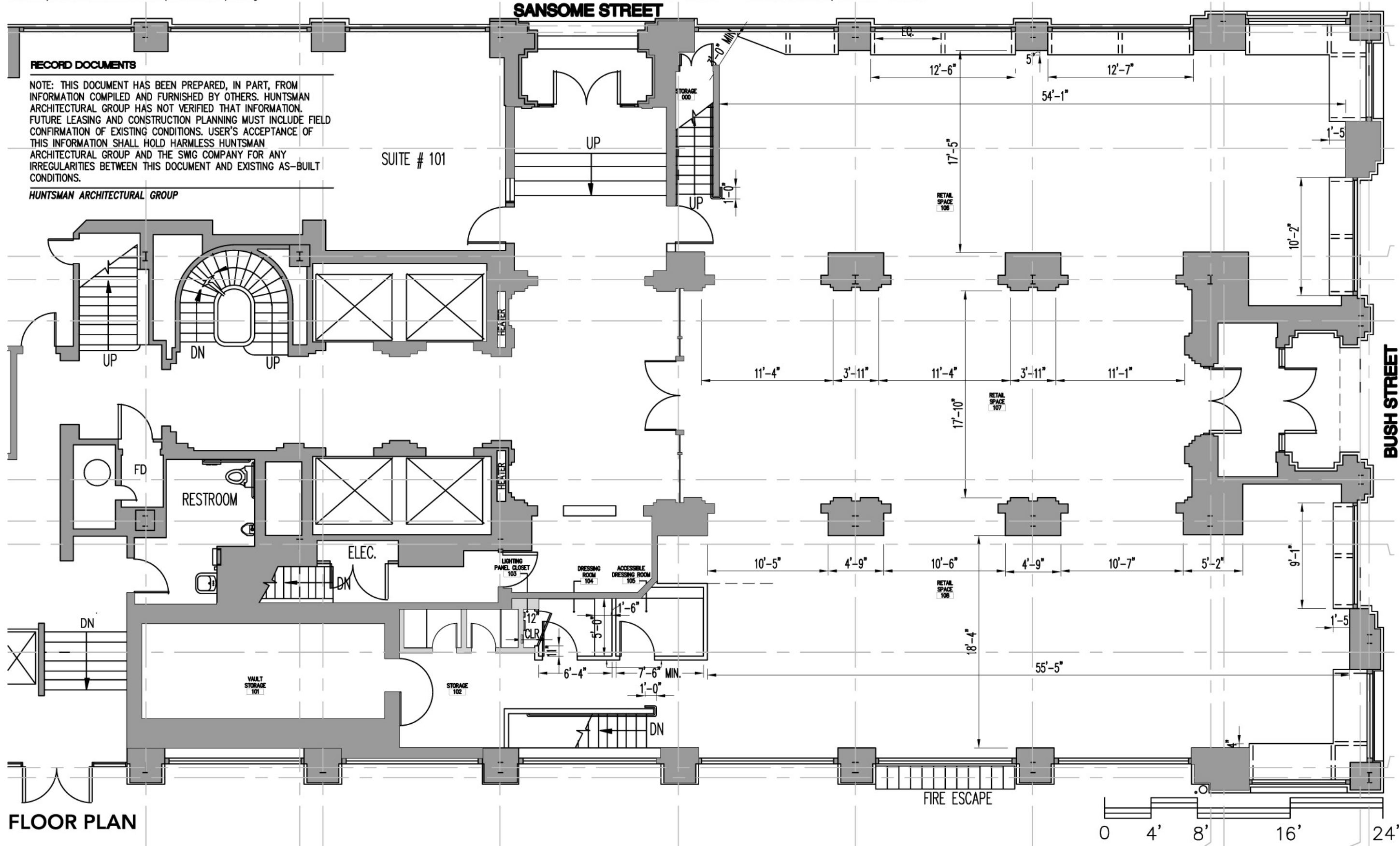

#### FLOOR PLAN

CABLE CAR CLOTHIERS/115 SANSOME

Size: 8,858 RSF 7,676 USF

**H HUNTSMAN** 12.13.06 SK-1  
N.T.S.